

88th GLANTON SHOW PROGRAMME 13th AUGUST 2011

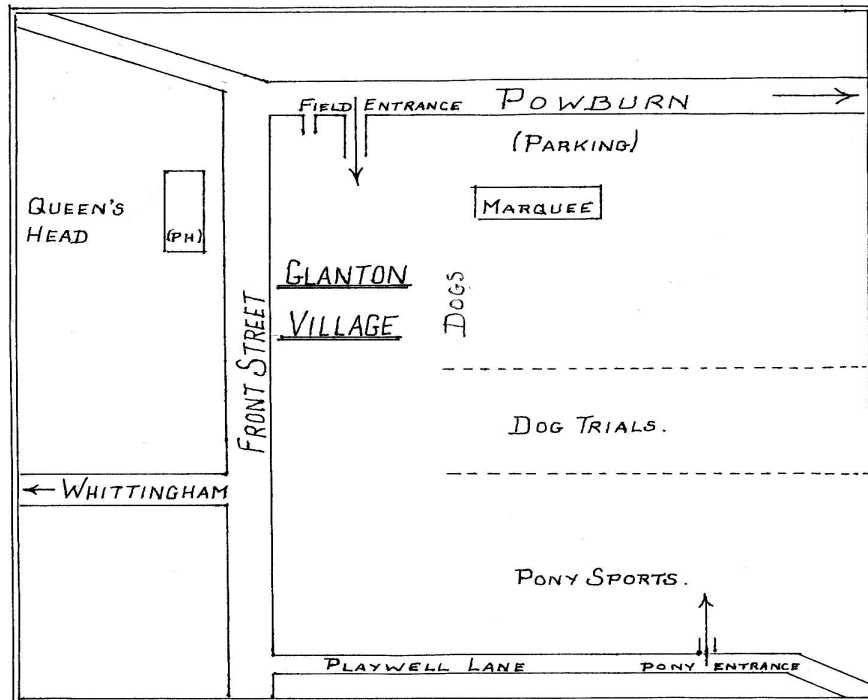

The Competitive Exhibits in the Horticultural and Industrial Classes
Will be staged in the Marquee on the Show Field.
The Pony Sports, Sheep Dog Trial, Dog Show, Children's Sports and other events will also
be held on the Show Field
on the Powburn Road

GLANTON AND DISTRICT
HORTICULTURAL AND INDUSTRIAL SOCIETY

PRESIDENT

Mrs. Susan Collingwood-Cameron

VICE-PRESIDENTS

Sir Ralph Carr-Ellison, Maj.R.H.F.Cowen, Mr.N.Dunn,
Mr.J.Foggon,Mrs.J.Gardner, Mr.& Mrs.A.F.C.Hunter, Mrs.A.Gibb
Miss.A.B.Henson, The Hon.Mrs.J.John, Mr.& Mrs.J.Moody, Mrs.J.Mothersgill,
Mrs.K.Waugh, Mrs.C.Westmacott, Mr.M.Thompson.

CHAIRMAN

Mr.A.Hindhaugh. Tel:- 01665 5785025

VICE-CHAIRMAN

Mr.J.Swanson. Tel:- 01665 578594

COMMITTEE

Mr.A.Aston, Ms.J.Blott, Mr.J.H.Burn, Mr.J.Easton, J.Guiry, Mr & Mrs P.Guiry,
Mrs M.M.Johnston, Mr.R.Johnstone, P.Lake, Mrs.M.Mason, Mrs I.Millar,
Mr.M.Mason, Mr.D.Rough, Mrs.J.Swanson, Fr.D.Tanner.

HON SECRETARY

Mrs.E.Knox, Old Wheelhouse, Whittingham. Tel:- 01665 574992.

ASSISTANT SECRETARY

Mrs.J. Swanson. Tel:- 01665 578594

HON TREASURER

Miss Sandra Nattrass, Glanton. Tel:- 01665 578222

AUDITOR

Mr.A.Purvis.

HORTICULTURAL SECTION

The John Fenwick Perpetual Challenge Cup will be awarded for Best Exhibit in Class 1.

The Eslington Perpetual Challenge Cup will be awarded for Best Exhibits in Class 2

The J.C. Thompson Perpetual Challenge Cup will be awarded for Best Exhibit in Classes 14 - 19.

The Red Lion Shield will be awarded for Best Exhibit in Classes 24 - 28.

The Pawson Perpetual Challenge Cup will be awarded for Best Exhibit in Vegetable Classes.

The Worshipful Company of Gardeners award 4 certificates, one each for flowers, fruit, vegetables and Class 58.

FLOWERS.

PRIZES : Classes 1 - 57 1st. £3.00, 2nd £1.50, 3rd. £ 1.00.

(Except where otherwise stated)

Classes.

1. 4 Roses. (One or more varieties).
2. 3 Vases Sweet Peas (dissimilar). 6 spikes of each.
3. Single rose.
4. 3 Spikes of Gladioli.
5. 1 Spike of Gladioli.
6. 2 Vases Annuals, Mixed, Hardy or Half Hardy. (Vase not to exceed 4" diam).
7. Bowl of mixed flowers grown on open border. (Bowl not to exceed 9" diam).
8. Mixed perennials. 1 vase. (Vase not to exceed 4" diam).
9. Bowl of Sweet Peas, any variety. (Bowl not to exceed 9" diam).
10. Hand Bouquet of Sweet Peas, outside grown, decoration allowed.
11. Lady's Spray and Gentleman's Buttonhole.
12. 4 French Marigolds.
13. Geranium. 1 Bloom Head.
14. 3 Medium Decorative Dahlias.
15. 3 Small Decorative Dahlias.
16. 3 Medium Cactus and/or semi-cactus Dahlias.
17. 3 Small Cactus and/or semi-cactus Dahlias.
18. 3 Pompom Dahlias.
19. 3 Ball Dahlias.
20. 4 Asters, single. (One or more varieties).
21. 6 Pansies.
22. 1 Pot Plant.
23. Amateur. 1 vase of mixed annuals..

FRUIT

24. Plate of Raspberries. (Tea plate size).
25. Plate of Redcurrants. (Tea plate size).
26. 12 Gooseberries. (Green , quality).
27. 12 Gooseberries. (Red, quality).
28. Plate of Blackcurrants. (Tea plate size).

VEGETABLES.

29. 1 Cauliflower.
30. 6 Pods Peas.
31. 6 Pods French Beans.
32. 6 Pods Broad Beans.
33. 6 Pods Runner Beans.
34. 3 Onions. **(1st £3.50, 2nd £2.00, 3rd £1.00).**
35. 3 Onion Sets. (flat).
36. 2 Blanch Leeks.
37. 3 Onion Sets. (Globe).
38. 2 Carrots. (Long)
39. 2 Carrots. (Stump).
40. 2 Beetroot. (Round).
41. 1 Vegetable and 1 Flower. (Spike or bloom).
42. Vegetable Collection - 3 varieties, one of each variety.
(1st £7.50, 2nd £5.00, 3rd £1.00).
43. 2 Parsnips.
44. 2 Celery. (Pink or White).
45. 2 Lettuce. (Cabbage).
46. 1 Cucumber.
47. Collection of Potatoes. 4 varieties. 3 of each variety.
(1st £3.50, 2nd £2.00, 3rd £1.00).
48. 3 Round Potatoes. (Coloured).
49. 3 Kidney Potatoes. (Coloured).
50. 3 Round Potatoes. (White).
51. 3 Kidney Potatoes
52. 1 Vegetable Marrow.
53. 6 Shallots. (Red, round).
54. 6 Shallots. (White, round).
55. 6 Shallots. (Pear Shaped).
56. 4 Tomatoes.
57. 1 Summer Cabbage.
58. Collection of vegetables: 4 varieties, 2 from each classes 29-57 with the exception of tomatoes, shallots, peas and beans which should be six.
(1st £7.50, 2nd £5.00, 3rd £3.00).
59. Basket of Plenty. One Basket or Trug of Garden Produce. To be judged on quality and presentation. Basket or Trug not to exceed 22" x 14".
(Prizes 1st £7.50, 2nd £5.00, 3rd £3.00).

FLORAL ARRANGEMENT.

The Francis and Bill Irving and Family Memorial Cup for the best exhibit in class 60 - 62.
The Worshipful Company of Gardeners award two certs. for the best entries in this section.
Flowers in Classes 60 - 62 need not be grown by the exhibitor.

(Prizes: 1st £2.50, 2nd £1.50, 3rd £1.00).

- 60. Table decoration. Not to exceed 18 inches.
- 61. Green Thought. An arrangement without flowers and in a basket. Space allowed 2ft.
- 62. Simplicity. An arrangement using no more than 5 flowers. Space allowed 1ft 6ins.

ART.

(Prizes: 1st £3.00, 2nd £1.50, 3rd £1.00).

- 64. A sketch.
- 65. A painting.
- 66. A sculpture or carving. Any medium.
- 67. A poem. Any subject.
- 68. A limerick about nature.

CHILDREN'S SECTION.

The Rev.R.Mayman Memorial Shield will be awarded for Most Points in this Section.
Faith Grant Memorial Trophy will be awarded for Best Exhibit in Classes 87 - 88.
The J.H.Stanners Memorial Cup for Best Exhibit in Class 92.
The Worshipful Company of Gardeners give two awards for the Best Exhibits in Classes 90 - 92.
All exhibits to be labelled with child's age on Show Day in years and months. Exhibits must not have child's name displayed.

Max 5 entries per exhibitor in each class.

(Classes 69 - 85. 1st £1.00, 2nd 70p, 3rd 50p).

(Classes 86 - 93. 1st £1.50, 2nd £1.00, 3rd 70p).

HIGH SCHOOL CHILDREN.

- 69. Handwriting. Eight lines, illustrated.
- 70. Picture. Any medium. (No larger than A3).
- 71. Gift wrapped present.
- 72. 1 Photograph. (1 entry per child only).

MIDDLE SCHOOL CHILDREN.

- 73. Handwriting. Poem not less than 6 lines. Decorate the borders.
- 74. Picture. Any medium (No larger than A3).
- 75. Sandwich cake. One tin. Jam filled. Not iced.
- 76. 1 Photograph. (1 entry per child only).

FIRST SCHOOL CHILDREN.

(4 to 5yrs)

- 77. Colour the picture provided.
- 78. A handpainted stone.
- 79. Handwriting. As specified.

(6 to 7yrs)

- 80. Picture. Any medium.(Not larger than A3).
- 81. Plasticine or playdough model.
- 82. Handwriting. As specified.
(With decorated border)

(8 to 9yrs)

- 83. Picture. Any medium.(Not larger than A3).
- 84. Model made from Lego. Max 100 pieces.
- 85. Handwriting. As specified.

ALL CHILDREN

- 86. Miniature garden. On a plate.
- 87. Edible necklace.(any edible food excluding sweets).
- 88. Decorated cookie.
- 89. Animal model made from vegetables.
- 90. Miniature flower arrangement less than 15cm height and width.
- 91. Single rose.
- 92. Collection of two varieties of vegetables and two varieties of flowers.
- 93. One Nature photograph.

HONEY

Isn't it funny
How a bear likes honey ?
Buzz! Buzz! Buzz!
I wonder why he does ?

SNAILS

Slimy and slippery,
Snails are such fun.
Slowly they move,
They can't even run.

Leaving their trail,
Behind as they go.
You can see where they've been,
And how very slow.

BIRTH OF A BUTTERFLY

A mama butterfly lays all her eggs,
Out pops a caterpillar, crawling on its legs.

The caterpillar first is rather thin,
then it eats till it bursts through its skin.

After growing nice and big,
The caterpillar climbs on a leaf or a twig.

It makes a shell where it hangs inside,
Then the shell cracks, and the parts divide.

Inside the shell, a change was going on,
The form of the caterpillar now is gone.

When the shell opens, what comes out?
A beautiful butterfly, fluttering about.

But

CLAY PIGEON SHOOT.

Sunday 17th July 2011. Commencing 10am. Last entries 12.30pm.
£100 in prize money * Other prizes * Cups.

SHEEP DOG TRIAL. (Open) to start at 10.30am.

1st prize Perpetual Challenge Cup, presented by the late Mr G Hope, \and £25

2nd prize £15. 3rd prize £10. 4th prize £8. 5th prize £5. 6th prize £3.

Entry fee of £4 per dog.

Entries in advance to the Secretary or on the field before 4.30pm.

A special prize of £10 will be donated to the highest placed competitor who has not won a 1st prize in an Open Trial.

PONY SPORTS AND JUMPING. (For children 16 and under).

Entries taken on the field from 1pm for prompt 1.30pm start.

JUBILEE CUP presented by Sir Ralph Carr Ellison.

PERPETUAL CHALLENGE CUP presented by Mrs.V.Thomas will be awarded for the most points.

ALN AND BREAMISH CUP presented by I.Coe for child aged 10 and under, gaining most points at Glanton, Whittingham,Powburn and Ingram Shows.

No whips or spurs allowed in gymkhana events. Rosettes for first four places.

COMPANION DOG SHOW. (Kennel Club Rules). At 2pm.

PERPETUAL CHALLENGE CUP presented by Mrs V.Thomas for the Best Dog in the Show. Classes for terriers, Sporting and Non-Sporting, Gun Dogs and Non-Pedigree dogs.

Children's handling classes.

Rosette for Best Dog in the Show and Reserve and the Best Puppy and rosettes for the first three places.

Entries £1 per class-taken on the field at 2pm.

TERRIER RACING. Time will be announced.

CHILDREN'S SPORTS, COMPETITIONS AND ENTERTAINMENTS

At 2.30pm. Entries taken on the field.

CHILDREN'S FANCY DRESS COMPETITION ETC. 12.30pm. Main Ring.

CRAFT STALLS -:- LIVE MUSIC -:- REFRESHMENTS AND BAR

VINTAGE CARS.

The MARQUEE WILL BE OPEN FROM 1.30pm (Approx) UNTIL LIFTING TIME 4.30pm.

COOKERY SECTION.

Breamish House Hotel Perpetual Challenge Cup will be awarded for the Best Exhibit in Classes 94 - 125.

The Carr Ellison Cup will be awarded for most points in Classes 94 - 125.

(Prizes: Classes 94 - 125. 1st £3.00, 2nd £1.50, 3rd £1.00).

94. Cherry cake.
95. Chocolate cake, single cake, butter cream filling, un-iced.
96. Sultana cake.
97. Date and walnut loaf..
98. Swiss roll. Jam filled.
99. Sandwich cake. Single tin. (Jam filled, not decorated).
100. Four pieces of no-bake traybake.
101. 4 Angel cakes.
102. Apple Tart on plate. Shortcrust pastry top and bottom.
103. 4 Sausage Rolls.
104. Corned beef pie. 8" short crust pastry.
105. Savoury flan. 8". (No dish allowed).
106. Lemon meringue pie.
107. Loaf. (Handmade).
108. Three brown bread buns.
109. Loaf of gingerbread.
110. MEN ONLY. Single Sandwich cake.(Jam filled. Not decorated)
111. 4 Girdle scones. (Currant).
112. 4 Cheese scones.
113. 4 Oven scones. (Plain).
114. 4 Shortbread Biscuits.
115. 4 Ginger Snaps.
116. 4 Hand made chocolate truffles.
117. Disaster Class. For the cookery exhibit that went wrong.
118. Raspberry Jam. (8oz jar minimum).
119. Strawberry Jam. (8oz jar minimum).
120. Blackcurrent jam. (8oz jar minimum).
121. Any variety of jam. (8oz jar minimum)
122. Marmalade. (8oz jar minimum).
123. Jelly. (1 jar).
124. Lemon Curd. (1 jar).
125. Chutney. (8oz jar minimum).

ATTENTION IS DRAWN TO THE HELPFUL HINTS ON BACK COVER

HANDICRAFT SECTION.

Silver Rose Bowl, presented by the late Mrs.T.A.S.Thompson to be awarded for best exhibit.

The Milly Thompson Trophy to be awarded for most points in Handicraft Section.

All entries must have been completed during the last twelve months.

(Prizes: 1st £3.00, 2nd £1.50, 3rd £1.00).

126. An item of bead work.
127. Baby's knitted matinee jacket.
128. Knitted garment. (Double knit).
129. Hand knitted garment. (3 or 4 ply).
130. Machine sewn article.
131. Piece of embroidery.
132. A cushion. Any craft.
133. Soft toy.
134. A hand made hat.
135. A piece of wool crochet.
136. A gift wrapped parcel.
137. Piece of patchwork.
138. Embroidered cross stitch picture. (Framed).
139. Piece of canvas work. (Framed).
140. Calligraphy. Four lines of verse.
141. A hand made greetings card.

STICKS.

The S.Hyslop Cup will be awarded for best exhibit in classes 143 - 150.

(Prizes: 1st £5, 2nd £3, 3rd £2).

143. Shepherd's Crook. Horn headed.
144. Shepherd's Crook. Plain. Wood Headed.
145. Dressed Walking Stick. Fancy horn head.
146. Horn headed walking stick. Plain.
147. Thumb Stick. Horn headed.
148. Half-Head Stick. Horn headed.
149. Fancy wood headed walking stick.
150. Novice class. Confined to exhibitors who have not won a 1st prize.

PHOTOGRAPHY.

The James Fenwick Tankard will be awarded for the best exhibit in the Photography Classes.

Maximum size 5" x 7". Please mount all photographs on paper or card with a 1" margin. No more than three entries per class.

(Prizes: 1st £3.00, 2nd £1.50, 3rd £1.00).

151. Mounted display of four local photos on a single theme.
152. One colour photo. Wild life.
153. One coloured photo. Animal or bird.
154. One portrait. Head and shoulders only.
155. One colour photo. Winter landscape.
156. One colour photo. (Plant life).
157. One black and white photo. (any subject).

GLANTON SHOW DONATIONS 2010

| | |
|--------------------------------------|---------------------------------|
| Mrs.M.Allen | Mr.K.Armstrong. |
| Mrs.G.Aynsley. | Mr.A.Balmbro.. |
| Mr/s. C.Beal. | Carr Ellison Estate. |
| Mr.&Mrs.R.Clark. | Mrs.Susan Collingwood -Cameron. |
| Country Life Homes & Pyke Nurseries. | Maj.R.Cowen. |
| Mr.D.& Mrs.S.Davidson. | H.Dinsdale. |
| Mr.J.Dodds. | Mr.Joe Easton. |
| Mrs.D.G.Ewart. | Mr.&Mrs.J.Foggon. |
| Mrs. GAP Forrest. | Mrs.A.M.Gibb. |
| Mrs.E.Gregg. | Mr. & Mrs. Guiry. |
| Ms.S.Herdman. | Mrs.E.Holmes. |
| Miss.I.Hunter. | Mr. & Mrs.Hunter. |
| Mr.J.Lang. | Mr.A.Meikle. |
| E.Moffat. | Mrs.N.Mordan. |
| Mr..Jon Radgick. | Mrs.J.Spours. |
| Mr.W.J.Stockdale. | Mr. & Mrs. Swanson. |
| Mr. & Mrs.A.Tait. | Mr. & Mrs. Telford. |
| Mrs.S.Thomas. | A.Tobin. |
| Mr.P.Turnbull. | Mr.R.Verrill. |
| Mrs.E.Thompson. | Ward Hadaway. |
| Weldon Gun Room. | C.Woodcock. |

RULES

1. Entries for all classes are free.
2. Each exhibitor in the Horticultural and Agricultural Sections, previous to placing any article for the competition, shall sign a declaration that the productions exhibited for prizes are bona-fide his own growth and they have been in his possession at least two months previous to the day of the Show. The Committee to have the power to visit any gardens at any time previous to the Show. In the Industrial and Children's sections, exhibitors must sign a declaration that the exhibits for the competitions are their own bona-fide work and have not won a prize in the same class at Glanton before. If the exhibitor does not conform to the declaration signed, or uses any deception with his flowers etc, the Committee, upon the facts being laid before them, shall have it in their power to withhold the prizes that may have been awarded and such exhibitor shall render himself liable to expulsion.
3. All disputes shall be referred to three members of the Committee and any person making the objections against an exhibitor must deposit £1.00 with the Secretary and if he proves his case his money will be refunded. Objections to be made in writing before the conclusion of the Show.
4. Any person may compete for more than one prize in any class.
5. Competent judges will be appointed by the Committee and their decision, in every case, shall be final. Should the judge consider the best exhibit in any class unworthy of a prize, no prize will be awarded, but the judges may award a prize to any article for which no prize is offered, but which, in their opinion, is of special excellence.
6. Forms of entry may be had from the Secretary, and the list of entries should be returned addressed to the Secretary, not later than Wednesday before the Show.
7. The marquee will be open for placing exhibits from 8am and must be staged by 10am. **THEY WILL BE CLEARED AT 4.30pm. THIS RULE WILL BE STRICTLY ENFORCED.**
8. The utmost care will be taken of the exhibits, but the Committee will not hold themselves responsible for loss or damage of the same.
9. Exhibitors must arrange for removal of their exhibits.
10. The Committee reserve the right to vary any of the Rules.
11. The Annual General Meeting will be held in Glanton Memorial Hall at 7.30pm on the first Wednesday in November.
12. All cups to be retained for one year only. Exhibitors to be responsible for their return to the Secretary by July 1st 2011

AUDITED ACCOUNTS ARE AVAILABLE FROM THE TREASURER.

TIPS FOR EXHIBITORS IN INDUSTRIAL SECTION

1. Read the schedule carefully. If a number of items or size is specified then stick to it.
2. Bread should be made 24 hours before judging.
3. Commercial tin liners should not be used. Show more skill by lining your own tins.
4. There should not be any cooling tray marks on the top of the cakes.
5. Savoury scones should be cut out using a plain cutter and can be glazed with egg or milk. A fluted cutter is used for sweet scones. These are not glazed.
6. A biscuit is normally rolled and cut out.
7. A cake or round of shortbread should be approx. 12mm (1/2 inch thick).
8. Pieces of tray bake should be of an even size and shape with all four sides being cut sides.
9. Pastry should be of an even thickness, evenly baked and if it is a tart or flan then the underneath should not be underdone.
10. Jars and lids used for preserves should be plain, with no trademarks or names on them, as these contravene the Trade Description Act.
11. If cellophane covers are used they also need a well fitting wax disc on top of the preserve.
12. If twist tops are used these they should be new and do not need a wax disc.
13. Lemon curd does not have a metal top.
14. Chutneys should have vinegar proof lids.

